

Parkray Aspect 5 Calm Flame Parkray Aspect 5 Pure Flame Parkray Arc Inset Calm Flame Parkray Arc Inset Pure Flame

Electric Stoves

Installation & User Manual

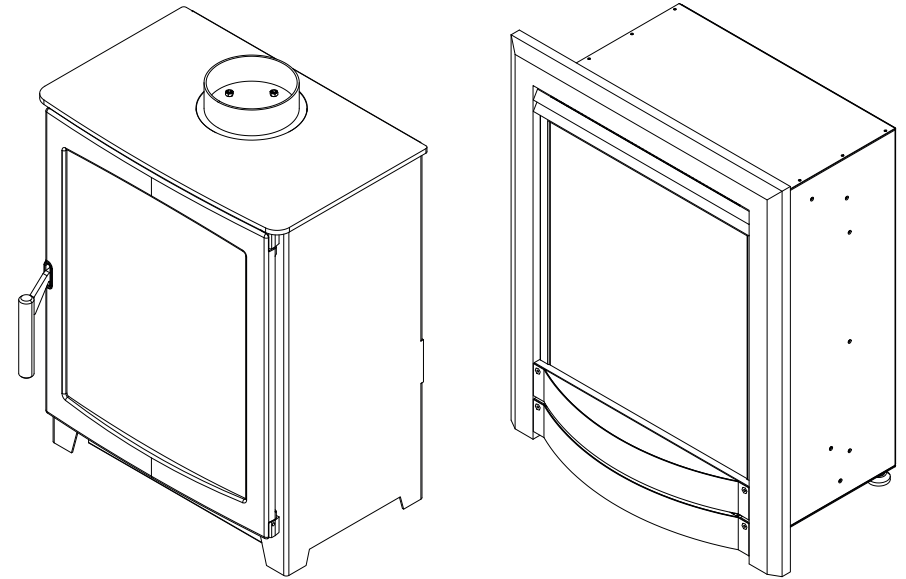

info@hunterstoves.co.uk www.hunterstoves.co.uk

Hunter Stoves reserve the right to change dimensions and procedures described in these instructions at anytime without special notice.

Registered address: Hunter Stoves Ltd., Trevilla Park, Slaughterbridge, Camelford, Cornwall, UK, PL32 9TT

Contents

1. Introduction	p3
2. Safety Information	p4
3. Packaging Contents	p5
4. Technical Specifications	p6
5. Product Dimensions	p7
6. Electrical Requirements	p8
7. Parkray Aspect 5 Appliance Installation	p9
8. Parkray Arc Inset Appliance Installation	p11
9. Operating the Appliance - Control Panel	p12
10. Operating the Appliance - Remote Control	p16
11. Operating the Appliance - Smart phone	p22
12. Pairing the Remote Control	p24
13. Heating System	p26
14. Maintenance	p27
15. Troubleshooting	p29
16. Warranty & Terms	p31
Appendix	
A. Optional USB Media Function (LCD Models)	p33

This page is left intentionally blank

This page is left intentionally blank

1. Introduction

Welcome to the Hunter Stoves family.

Thank you for choosing a Hunter electric fire. Designed to combine refined aesthetics with intelligent heating technology, this appliance delivers the atmosphere of a real fire alongside modern, efficient comfort.

Our electric fires are developed with the same attention to quality, performance, and safety as our traditional stoves. Features such as electronic temperature control, programmable timers, and carefully crafted flame visuals allow the appliance to respond to your space and lifestyle.

This appliance is intended for domestic use and is supplied with this Installation and User Manual, which should be retained for future reference.

Please read this manual carefully before installation and use to ensure safe and correct operation. If any information is unclear, applicable national and local regulations should always be observed.

2. Safety Information

a. General

Please read all instructions carefully before installing or operating this appliance. Failure to follow these instructions may result in electric shock, fire, personal injury, or damage to property.

This appliance must be installed and operated in accordance with this manual and all applicable national and local regulations.

Hunter Stoves cannot accept responsibility for any fault or damage arising from incorrect installation, misuse, or unauthorised modification of this product.

This appliance is intended for indoor domestic use only.

b. Safety Instructions

- This appliance must be connected to a 220–240V AC, properly earthed supply.
- Do not modify, alter, or tamper with the appliance or its electrical components.
- Do not operate the appliance if it is damaged, incomplete, or has been exposed to water.
- Do not cover the appliance or obstruct air inlet or outlet openings.
- Do not place on surfaces which may obstruct air inlet (such as carpets).
- Keep combustible materials, furniture, curtains, and soft furnishings clear of the appliance.
- Do not place objects on or directly in front of the heater outlet.
- Do not use the appliance in bathrooms, shower rooms, or other high-humidity environments.
- Always switch OFF and unplug the appliance before cleaning, maintenance, or relocation.
- If you are unsure about installation requirements, electrical supply, or safe operation, consult a qualified electrician or professional installer before use.

WARNING!

This appliance is a heating device. During operation, the glass and surrounding metal surfaces may become warm to hot. Avoid direct contact during use to prevent burns.

Although the appliance is designed for controlled domestic heating output, care should always be taken when the unit is operating, particularly around children and vulnerable persons.

Appendix A - Optional USB Media Function (LCD Models)

The LCD appliance is equipped with a USB port that allows flame video content to be updated using a USB storage device.

The appliance is supplied with pre-installed flame videos, which are factory-set and optimised for the product.

These original videos are exclusively provided and are recommended for normal operation. All flame video content is created and owned by Hunter Stoves and is protected by copyright. It must not be copied, distributed, modified, or used for any other purpose without prior written permission.

Important Notice :

Use of the USB video function is optional and not recommended during initial setup or early use of the appliance.

For the latest supported flame videos and USB update instructions, please refer to the official support resources provided by Hunter Stoves.

Website: <https://www.hunterstoves.co.uk/>

c. Exclusions

This warranty does not cover:

- normal wear and tear, cosmetic deterioration, paint scratches or surface blemishes;
- accidental damage, misuse, neglect, incorrect installation, or lack of maintenance;
- damage arising from water ingress, damp conditions, condensation, weather exposure or corrosive cleaners/chemicals;
- breakage of the glass panel;
- consumable decorative items including (but not limited to): logs, coals, bark, rear panels.

No liability is accepted for:

- any third-party work or parts fitted without prior written authorisation;
- any consequential loss, incidental damage, property damage or installation/removal costs.

d. Making a Claim

If a claim is to be made under this warranty, and all terms and conditions have been met, please contact your authorised dealer, who will liaise with our Service Department where necessary, in the first instance. To proceed, the dealer will require:

- proof of purchase,
- product model,
- a description of the fault.

Repairs or assessments must not be carried out by any third party without prior written authorisation from the dealer and/or our Service Department. Costs incurred without prior approval will not be reimbursed.

e. Legal Notice

This warranty does not affect your statutory rights under UK consumer law.

3. Packaging Contents

- Note the items listed in the table below when removing the packaging.
- Check the appliance and accessories for any damages.
- Please contact the supplier if any of the components are missing or damaged.
- Dispose of all packaging materials in accordance with local regulations and keep plastic bags away from children.

Packaging Checklist	
Item	Description
Appliance	Electric fire unit
Instructions and Documentation	Installation, operation, safety, and maintenance instructions
Front Glass Suction Cup	For safe removal and installation of the front glass
Remote Control	Handheld remote control
Batteries	2 × AAA batteries (for remote control)
Reset Pin	Used to restore factory settings
Flue Collar (Parkray Aspect 5 freestanding models only)	Decorative flue collar

4. Technical Specifications

Model Identification	See appliance rating plate
Type of Appliance	Electric Fire
Installation Type	Parkray Aspect 5: Freestanding Parkray Arc Inset: Built-in
Fuel Type	Electric
Rated Voltage	220–240V AC
Rated Frequency	50/60 Hz
Rated Frequency	1500 W
Heat Output Levels	Low (750W) / High (1500W)
Temperature Control	Electronic room temperature control (10°C to 30°C)
Control Methods	On-unit control panel / Remote control / Smart phone app
Timer Functions	Sleep timer (0–8 h) / Weekly timer
Automatic Temperature Control	Yes
Overheat Protection	Thermal cut-out safety device
Flame Effect	LED models: Light Emitting Diodes LCD models: Liquid-Crystal Display
Lighting Type	LED
Energy Efficiency Compliance	Lot 20 compliant
Electrical Protection Class	Class I (earthed appliance)
Energy Efficiency Class	UK 3-pin plug (BS1363), 1.5 meters cable
Plug Type	117.6
Intended Use	Indoor domestic use only
Manufacturer Details	Hunter Stoves Ltd. Trevilla Park, Slaughterbridge, Camelford, Cornwall, England, PL32 9TT info@hunterstoves.co.uk www.hunterstoves.co.uk

16. Warranty & Terms

The Hunter Stoves Ltd team takes great pride and considerable care to make sure the flame products offered are designed, tested and manufactured to exacting standards and to the highest quality possible. Our goal is for you to love your purchase, year after year.

1 Year Standard Warranty

Any appliances bought through an Internet Supplier are covered for 12 months only and do not qualify for any extended warranty periods.

2 Year Standard Warranty

Any appliances bought through an authorised Hunter Stoves Ltd retailer (dealership / showroom) will automatically be covered by our standard guarantees, as follows:

Electric appliances are covered by our standard 2-year conditional guarantee.

a. Warranty Coverage

The appliance is warranted to be free from defects in materials and workmanship for two years from the date of purchase.

During the warranty period, any component proven to be defective in manufacture will be repaired or replaced, provided that:

- the fault has been reported to us in advance, and
- repair or replacement has been authorised by Hunter Stoves via an approved retailer.

b. Conditions of Warranty

This warranty is valid only where:

- the product has been installed and operated strictly in accordance with the installation and user instructions and in a correctly ventilated space;
- proof of purchase is supplied upon request;
- the product has been purchased through an authorised stockist or retailer.

The warranty period shall not be extended due to any replacement or repair carried out under warranty.

Fault	Possible Cause	Solution
Heater Turns OFF Automatically	Target temperature has been reached	The fan may continue running briefly after heating stops
	Weekly or sleep timer has completed	Heating will restart automatically if room temperature falls below the target (when temperature control is active)
	Heater has entered cooling cycle	
Temperature Display Appears Incorrect or Does Not Update	Display shows last measured temperature	Press the Heat button once to trigger a new temperature reading <i>(Note: Displayed temperature values are indicative and intended for comfort control, not precision measurement.)</i>
	Temperature is not updated continuously	
Timer or Weekly Schedule Does Not Operate as Expected	Weekly programme not enabled (Timer 7/24 indicator not shown)	Confirm Timer 7/24 icon is displayed
	Programme not fully configured	Verify day(s), start time, end time, temperature, and heater level are all set for the programme
	Heater level set to OFF within the timer group	Ensure heater level is not OFF if heating is required
Appliance Turns ON Without Heating During a Timer Event	Explanation: A timer group may be configured with heater level set to OFF	This is normal behaviour if: Only flame and lighting are intended during the scheduled period
Unusual Sounds or Smells	Gentle motor or fan noise	Light motor sound is normal during flame operation
	Slight odour during first use	A slight odour may occur during first heating use and will dissipate with ventilation
	Odour after inactivity period	Vacuum the air vent
Display Icons or Indicators Not Showing as Expected	Appliance or remote in standby	Press the relevant button again to confirm current status
	Indicator timed out automatically	Wake the remote if no icons are shown

5. Product Dimensions

a. Parkray Aspect 5

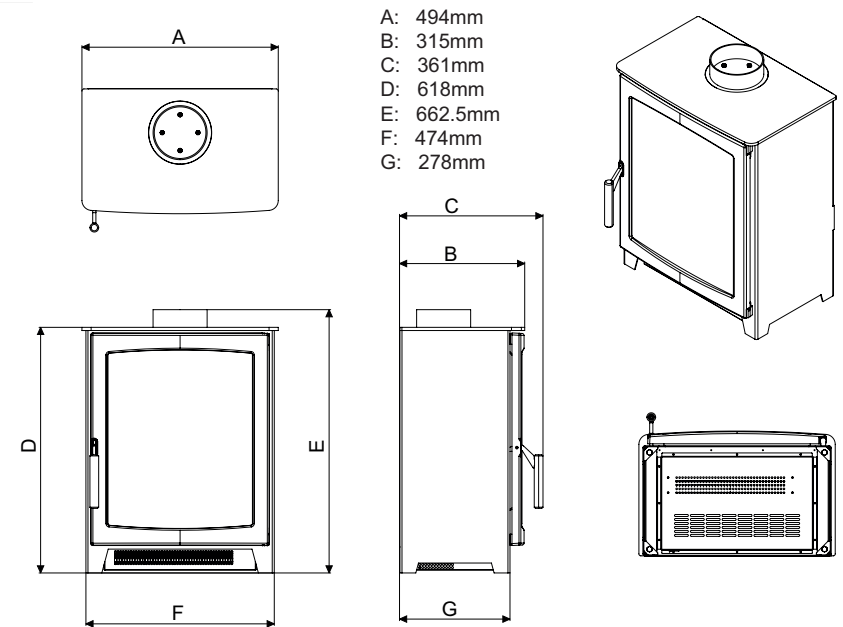

b. Parkray Arc Inset

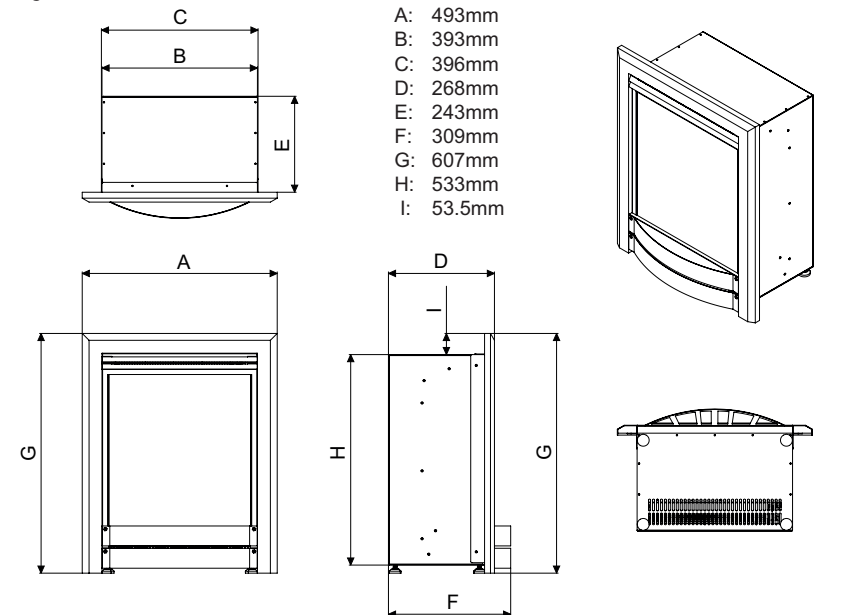

6. Electrical Requirements

This appliance must be connected to a 220–240 V~ / 50–60 Hz, properly earthed electrical supply capable of supplying at least 7.5 A.

The appliance must be connected directly to a fixed socket outlet or fused spur.

Do not use extension leads, multi-way adaptors, or trailing cables.

The plug or isolation point must remain accessible after installation for safe disconnection.

WARNING!

Do not operate the appliance if the power cable, plug, or socket shows signs of damage, overheating, or looseness.

If in doubt, consult a qualified electrician before use.

15. Troubleshooting

Fault	Possible Cause	Solution
Appliance Does Not Turn ON	Appliance not connected to power supply	Confirm the appliance is plugged into a working 220–240V socket
	Mains power switch is OFF	Ensure the mains power switch on the appliance is ON
	Wall socket has no power	Test the socket with another appliance
	Remote control batteries are depleted	Check that the remote control indicator light responds when any button is pressed
Remote Control Not Responding	Batteries installed incorrectly or depleted	Replace both AAA batteries and confirm correct polarity Press any button and check for the red indicator light
	Remote not paired with the appliance	Re-pair the remote following Section 12
	Remote out of operating range	Ensure you are within normal operating distance
	Remote and appliance are out of sync after a power interruption	Press the Power button on the remote to switch the appliance OFF, then ON again
Appliance Responds to On-Unit Buttons but Not the Remote	Remote batteries low during pairing attempt	Replace batteries before pairing
	Remote control pairing lost	Follow one pairing method only (do not mix methods) Ensure pairing is completed within the timing window
Flame or Lighting Works but No Heat Output	Heater set to OFF	Press Heat button to select Low or High heat
	Target temperature already reached	Check the set target temperature
	Heater level not selected in timer program	If using Weekly Timer, confirm heater level is set to Low or High (not OFF)
	Overheat protection in place	If overheat protection has operated, allow the appliance to cool fully, ensure the vents are clear, then switch the appliance back ON

c. Handling & Wear

The appliance is prepared with a durable powder-coated paint finish. As with all powder-coated metal surfaces, minor wear at contact or friction points is unavoidable during normal use.

Areas subject to regular movement or contact—such door handle / access panel—may show gradual wear over time.

This type of wear is considered normal and does not affect the operation or safety of the appliance.

When moving / positioning the flue collar component on freestanding models, avoid excessive sliding or force against painted edges to prevent surface wear.

Front Glass Handling

The front glass on Inset models is pre-installed at the factory, together with the real wood fuel bed. In normal use, glass removal is not required.

Removing the Front Glass

If glass removal is necessary due to special circumstances, proceed with care.

- Remove the top small curved trim beneath the log bed.
- Using the glass suction cup provided, hold the glass firmly with one hand.
- Lift the glass upward while supporting the lower edge from beneath.
- Gently pull the glass outward from the base to remove it from the frame

Reinstalling the Front Glass

- Using a glass suction cup, guide the glass into the upper slot first.
- Support the lower edge by hand and carefully ease it back into the lower slot.
- Once fully seated, release the suction cup.
- Refit the small curved trim.

Note: Always handle the glass carefully and avoid placing it on hard or uneven surfaces.

d. Remote Control

The remote control uses two AAA 1.5V batteries. Replace batteries when response becomes slow or inconsistent. After replacing the batteries, the remote does not need to be paired again.

e. Storage

If the appliance is not to be used for an extended period:

- Disconnect it from the power supply.
- Store in a clean, dry location, protected from moisture and dust.

7. Parkray Aspect 5 Appliance Installation

a. Positioning Requirements

The Parkray Aspect 5 freestanding appliance is supplied fully assembled and requires no installation. Place the appliance on a stable, level surface in a suitable location.

Note: The warm air outlet is located at the bottom of the appliance.

Minimum Clearances (Parkray Aspect 5 Freestanding only)	
Item	Minimum Clearances (mm)
Bottom of appliance to floor	0
Sides of appliance	0
Back of appliance	0
Top of appliance	200
Front of appliance to combustibles	1000

WARNING!

Do not place the appliance on carpets, rugs, or surfaces that may restrict airflow. Where a log store is fitted, avoid overfilling and ensure airflow to the inlet is maintained.

Select a location that is not prone to moisture, and the front of warm air outlet is located at least 1000mm away from combustible materials such as curtains, drapes, furniture, bedding, or other combustible materials.

b. Adaptable Decorative Flue Collar – Installation Options

The appliance is supplied with an adaptable Flue Collar, designed to offer two alternative top finishes.

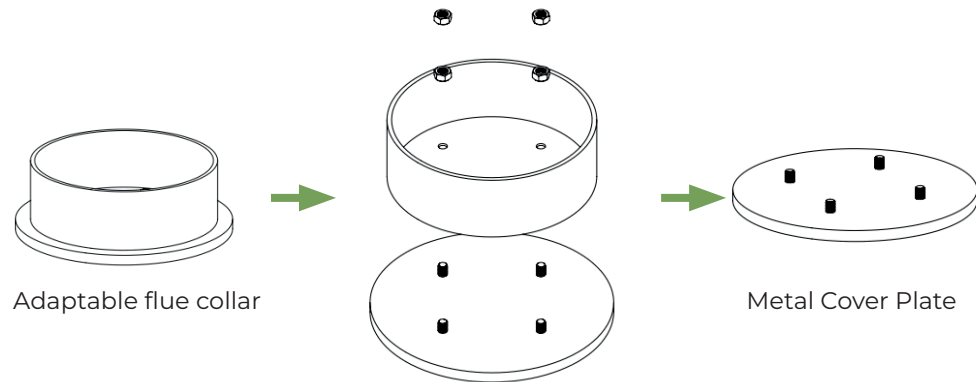

Option A: With flue collar to connect to standard 5" (127mm) flue

Supplied fully assembled. Simply place the flue collar into the circular recess on the top panel. No fixings required.

Option B: Flush top finish

Remove the metal cover plate by unscrewing the nuts on the inside of the collar, then invert the metal plate, align the posts with the holes and place into the top recess. No fixings required.

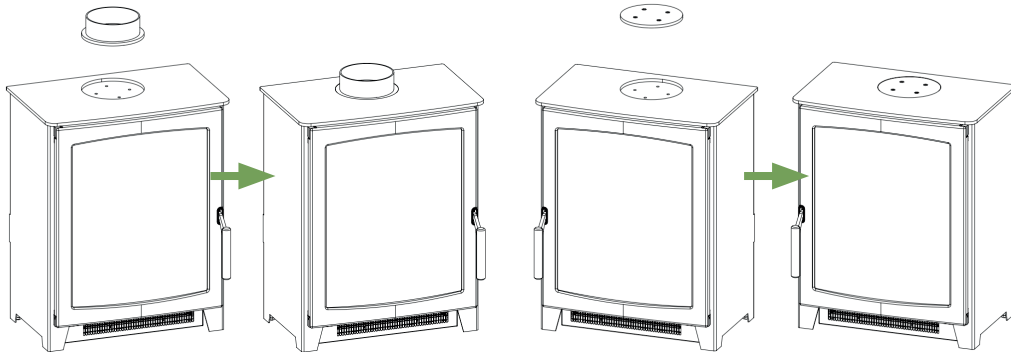

Note: Once fitted in Option B – Flush Top Finish, it may be difficult to remove this plate. Please choose your preferred configuration before installation.

14. Maintenance

Proper care and maintenance will help ensure safe operation and preserve the appearance of the appliance over time.

a. Safety

- Never immerse or spray the appliance with liquid.
- Do not allow moisture to enter electrical components.
- Ensure all air intake and outlet vents remain clear and unobstructed during use.
- There are no user-serviceable parts inside the appliance.
- Do not open any panels. Internal electrical components and fan motors are factory assembled and require no lubrication or adjustment.
- Any servicing or repair must be carried out by a qualified electrician.

IMPORTANT NOTE

Always switch OFF and unplug the appliance from the mains power supply before cleaning, maintenance, or moving the appliance. Failure to do so may result in electric shock or personal injury.

b. Cleaning and Surface Care

For routine care, regular dusting is normally sufficient. No special maintenance procedures are required.

Glass

- Clean using a soft, dry cloth or a cloth lightly dampened with a suitable glass cleaner.
- Always spray cleaner onto the cloth, not directly onto the glass.
- Dry thoroughly with a lint-free cloth.
- Do not use abrasive cleaners or materials that may scratch the surface.

Metal and Plastic

- Wipe with a soft, lint-free cloth, or a very soft brush.
- Do not use household cleaners, polish, abrasive products, or sprays, as these may damage the finish.

Air Vents

- Remove dust and debris periodically using a vacuum cleaner with a brush attachment or a soft duster.
- Do not block or cover vents during operation.

13. Heating System

This appliance does not only turn heat on and off — it manages heat intelligently based on output level, room temperature, and user preferences.

a. Rated Power and Heat Output

The appliance has a rated heating power of 1500 W and is equipped with two changeable heat output levels:

- Low heat – 750W
- High heat – 1500W

b. Intelligent Automatic Temperature Control

When a target temperature is set using the remote control, the appliance operates with **automatic room temperature control**.

- The appliance monitors the room temperature and manages heating automatically.
- Heating will switch ON when the room temperature falls below the selected target.
- Heating will switch OFF once the target temperature is reached.
- If the room temperature drops again, the heater will restart automatically to maintain comfort.

This closed-loop operation maintains a stable and comfortable environment without constant user adjustment, while helping reduce unnecessary energy use.

Flame effects and lighting functions operate independently from the heating system and may continue running even when heating is off.

c. System Behaviour and Display Information

The temperature shown on the remote display represents the last measured room temperature.

- The displayed value **is not updated continuously**.
- A new temperature reading is taken when the Heat function is accessed again.

This display behaviour is normal and does not affect heating performance.

- After heating switches off, the heater fan may continue to run briefly.
- This is a normal cooling cycle designed to protect internal components.
- The temperature control system is designed for comfort regulation in domestic spaces, not for precision climate control.
- Displayed temperature values are indicative and intended for everyday use.
- The temperature unit can be switched between Celsius (°C) and Fahrenheit (°F) by pressing and holding the Heat button for approximately 5 seconds.

8. Parkray Arc Inset Appliance Installation

Note: We recommend installation is carried out by a qualified and experienced installer where building work is required.

Recommended Wall Opening	
Width	406mm / 16"
Height	560mm / 22"
Depth	265mm / 10.5"
Minimum Clearances (Parkray Arc Inset only)	
Item	Minimum clearances (mm)
Bottom of appliance to floor	0
Sides of appliance	0
Back of appliance	0
Top of appliance	200
Front of appliance to combustibles	1000

The Inset appliance is supplied fully assembled and requires no on-site assembly.

Position the appliance by carefully sliding it into the pre-constructed wall opening. No mechanical fixing is required when installed correctly within the recess.

The heater and fan assembly is located in the upper section of the appliance. Warm air is discharged from the upper air outlet, concealed behind the angled decorative trim above the glass panel.

9. Operating the Appliance - Control Panel

a. Control Methods

The appliance can be operated using the following control methods:

i. On-unit Control Panel

Provides basic operation and system-level functions. This is the only interface used for **factory reset and pairing** of the remote control or smart phone app. It may be used for temporary operation if the remote/app is unavailable.

ii. Remote Control

Designed for **daily operation** and convenient access to the full range of lighting and heating functions. The remote allows more detailed control than the on-unit panel and is intended as the primary day-to-day interface.

iii. Smart Phone Application

Provides the most advanced and user-friendly control experience. The app offers the clearest interface for setting timers and schedules, and is recommended for users who prefer smart home integration or require an alternative control method if the remote is unavailable.

iv. Voice Control (Alexa)

Enables basic voice control of the appliance, including switching the appliance ON or OFF.

Each control method offers a different level of access and functionality. If different control methods are used, the appliance will follow the most recent command received. Detailed operating instructions for each control method are provided in the following sections.

Note: If the appliance has been turned on from the on-unit control panel, after it has been turned off at the plug, the remote will not work and needs to be turned off and on again to resume normal functioning.

b. Control Panel

The on-unit control panel provides access to basic operation and system-level functions. It may be used for initial setup, emergency operation when the remote is unavailable, and system reset.

I. Accessing the Control Panel:

Parkray Aspect 5 Freestanding models:

- Open the front door to access the buttons below the log bed.

Parkray Arc Inset models:

- Remove the top small curved trim beneath the log bed to reach the buttons.

Note: If the appliance has been idle, the first button press may only wake the unit. Press the same button again to operate normally.

d. Important Notes

- Pressing the remote multiple times during the pairing window is recommended to clearly confirm synchronisation.
- If the pairing window expires, simply repeat the selected method from the beginning. On LED models, a yellow indicator appears in the top-left corner of the flame picture while pairing window is active.
- Low or incorrectly installed batteries may prevent successful pairing.

e. If Pairing Fails:

- Replace the remote batteries and try again.
- Ensure no other pairing method is being attempted at the same time, and that no other nearby devices are interfering with the pairing process.
- Keep the remote close to the appliance during pairing.

12. Pairing the Remote Control

The remote control is factory paired before shipment. In normal use, no pairing is required. Only follow the steps below if the appliance does not respond to the remote.

a. Before you Start

- Ensure two AAA batteries are correctly installed and that the red indicator light on the top of the remote responds when any button is pressed.
- Make sure the appliance is connected to the mains power supply.
- Stand within 4 metres of the appliance during pairing.

IMPORTANT NOTE

Use one pairing method only.
Do not attempt both methods at the same time.

b. Method 1 – Manual Pairing via Control Panel (Recommended)

Use this method if the appliance **is already operating**.

- Ensure the appliance is ON.
- Firstly, press and hold the Power button on the control panel for 5–7 seconds.
- Then a 7-second pairing window on the device will open.
- During this time, press the Power button on the remote several times.
- The appliance will respond, confirming successful pairing.

Pairing is complete when the appliance responds to the remote control.

c. Method 2 – First Power-On Pairing

Use this method when the appliance is **powered on at the mains**.

- If the appliance has been switched OFF, wait at least 10 seconds before switching it ON again.
- This allows the electronics to fully discharge.
- Switch the appliance ON at the mains power switch. A 7-second pairing window on the device will open immediately.
- Within 7 seconds, press the Power button on the remote several times.
- The appliance will respond (turning ON/OFF), confirming successful pairing.

Pairing is complete when the appliance responds to the remote control.

i. Control Panel Function Overview

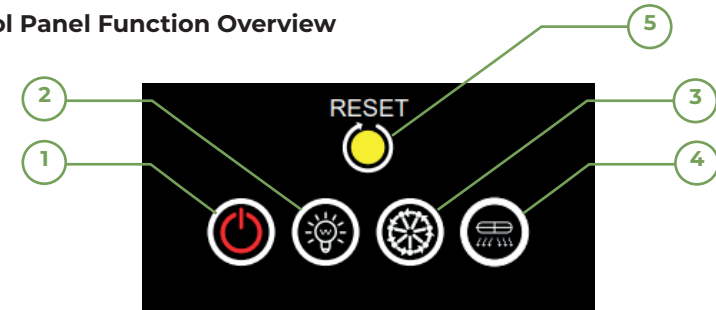

Front of Appliance		
No.	Button	Quick Use
1	Power	Turns the appliance ON or OFF
2	Brightness	LCD models: Adjusts log bed & top light brightness LED models: Adjusts flame, log bed & top light brightness (10 levels, cycles lowest → highest)
3	Flame Picture / Colour	LCD models: cycles through flame pictures LED models: cycles through 8 flame colours
4	Heat	Low → High → Off (indicator lights show level; fan may run briefly after OFF for cooldown)
5	Reset	Press and hold for 5–7 seconds to restore factory settings (clears remote pairing)

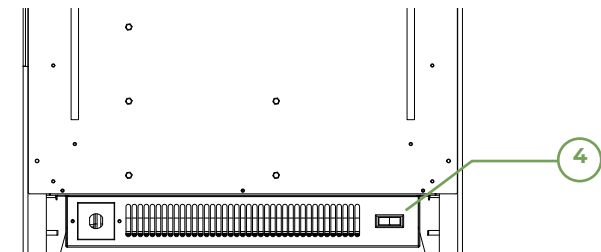

Rear of Appliance (Freestanding only)		
No.	Button	Quick Use
6	Aura glow	Ambient backlight behind the appliance

II. Detailed Control Panel Function - Power

Press once: Turns the appliance ON. Indicator light illuminates and all enabled functions become active.

Press again: Turns the appliance OFF. The unit enters standby mode and all functions are disabled.

Power Confirmation (What You Will See)

LCD models: The Hunter Stoves logo will appear on the display, and the ember/log bed will light up and glow constantly.

LED models: The flame effect and glowing ember/log bed will illuminate immediately and continue running.

III. Detailed Control Panel Function - Brightness

Each press adjusts the flame and log bed brightness, cycling through available levels from low to high.

The selected brightness level remains active until changed or the appliance is switched OFF.

IV. Detailed Control Panel Function - Flame Picture / Colour

LCD models: Cycles through available flame pictures.

LED models: Cycles through available flame colour options.

The selected flame setting is retained during normal operation.

V. Detailed Control Panel Function - Heat

Press the Heat button to activate or change the heat level. A quiet click may be heard when the heat level changes.

Heat Level	LED Models	LCD Models
Low	Press the heat button until a yellow indicator light appears in the top of the flame picture.	Press the heat button until the word “Low” appears at the centre of the screen.
High	Press the heat button until a red indicator light appears in the top of the flame picture.	Press the heat button until the word “High” appears at the centre of the screen.
Off	Press the heat button until no indicator light appears in the top of the flame picture.	Press the heat button until the word “Close” appears at the centre of the screen.

d. App Functions

Using the app you can:

- Turn the appliance ON / OFF
- Control lighting colours and brightness
- Adjust heat level and target temperature
- Set a sleep timer
- Set a 7-day heating programme (schedule)

e. Heat Programme (Weekly Schedule)

The Heat Programme allows you to set:

- Day(s) of the week
- ON / OFF times
- Heater level (Low / High / Off)
- Target temperature

f. Bluetooth Assisted Setup (Optional)

In some cases, the appliance may also be added to the app using Bluetooth-assisted setup:

Power on the appliance and enable **Bluetooth** on your mobile device.

Open the **Smart Life app**; the device may appear automatically.

Select **Add**, then follow the prompts to complete Wi-Fi setup.

Note:

App availability and features may vary depending on region and app version.

g. Connect to Alexa (Optional)

- You can link your appliance to Amazon Alexa using the Smart Life app.
- Download the Amazon Alexa app and sign in with your Amazon account.
- Open the Smart Life app.
- Go to Me → Voice Services → Amazon Alexa.
- Tap Sign in with Amazon.
- The Alexa app will open automatically.
- Tap LINK to complete the account linking.
- Once linked, Alexa integration is complete. You can name your appliance in Alexa, then using voice command "Alexa, turn on/off the (your appliance name).

11. Operating the Appliance - Smart phone Application

The appliance can also be controlled using a smart phone app via Wi-Fi, providing the most intuitive control experience.

While the same functions are available on the remote control, the smart phone app also offers a clear and intuitive interface for setting and managing schedules.

a. App Compatibility

Compatible with Apple (iOS) and Android devices
Requires a 2.4 GHz Wi-Fi network
(5 GHz networks are not supported)

b. Downloading the App

Download Smart Life – Smart Living from:

- Apple App Store
- Play Store

Create a user account and log in before proceeding.

c. Connecting the Appliance to the App (Wi-Fi Pairing)

- Switch ON the appliance using the control panel or remote control.
- Open the Smart Life app and select Add Device.
- Choose Small Home Appliances → Electric Fireplace (Wi-Fi).
- Select your 2.4 GHz home Wi-Fi network and enter the password.
- Put the appliance into pairing mode:
- Press and hold the Flame Picture (See picture below) on the on-unit control panel; the flame and fuel bed lights will begin flashing in a certain pattern.
- In the app, select Blink Quickly/Slowly according to the flashing pattern and follow the on-screen instructions
- Pairing will complete automatically once successful.

After pairing, the appliance can be controlled directly from the app.

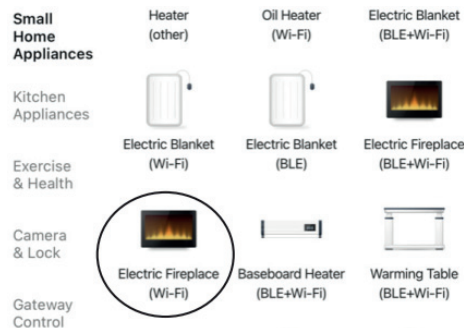

Smart Life –
Smart Living App

VI . Heat indicator light behaviour

- The yellow or red indicator (LED) / level shown on Display appears for **approximately 5 seconds** to confirm the selected heat level, then turns off automatically.
- The indicator turning off does not mean heating has stopped.
- Heating continues in the selected mode until changed or switched off.

If the indicator has already turned off, press the Heat button once to display the current level, then press again to change it.

VII. Detailed Control Panel Function - Reset Function

The control panel is the only interface used to perform a system reset.

- Insert the supplied reset pin into the RESET hole on the control panel.
- Press and hold for 5-7 seconds to restore the appliance to factory settings.
- On LED models only, a successful reset is confirmed by the three indicators at the top of the flame picture (two yellow and one red) flashing three times.
- This confirmation is shown only if the remote has previously been paired. If the appliance is already in factory state, the indicators will not flash.
- This process will clear all remote and app pairing data.

After a reset, the remote control and smart phone app must be paired again before use.

VIII. Detailed Control Panel Function - Aura Glow

Parkray Aspect 5 models are equipped with an ambient Aura Glow light designed to softly illuminate the wall or recess behind the appliance and enhance the overall atmosphere.

Switch Location

The Aura Glow has a physical ON/OFF switch located on the rear right lower side of the unit (right hand side when looking at the back panel).

Colour Control

The Aura Glow shares the same colour channel as the fuel bed.

10. Operating the Appliance - Remote Control

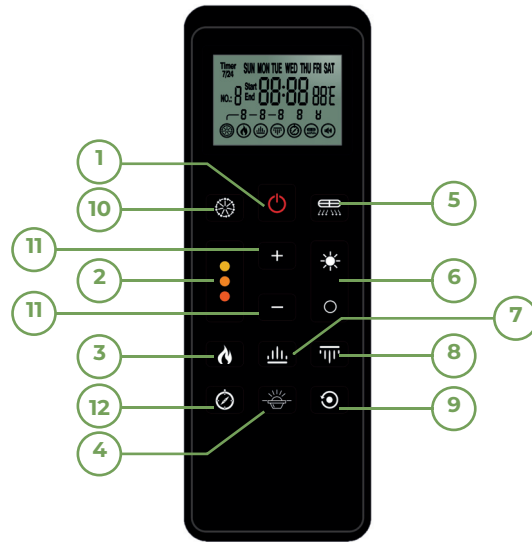

Remote Control Button Overview

No.	Button	Quick Use
1	Power	Turns the appliance ON or OFF
2	Colour	Adjusts all lighting colours (LCD: not applicable to flame video scenes)
3	Flame Picture	LED: Adjust flame LCD: switches flame video scene
4	Log Uplight	Turns ON/OFF the upward spotlights for logs
5	Heat	Low → High → Off (Automatic heat control: refer to Section 13)
6	Brightness	Adjusts brightness of flame, log bed & top lighting
7	Fuel Bed	Adjusts fuel bed colour
8	Top light	Adjusts top light colour
9	Restore	Restores default lighting
10	Mode	Cycles lighting mode effects (<i>Advanced</i>)
11	Adjust (+/-)	Adjusts values in advanced settings
12	Timer	Accesses timer functions (<i>Advanced</i>)

XI. Confirming and Saving

After completing a group, the setup will return to timer group selection, allowing additional groups to be configured. If no button is pressed for approximately 10 seconds, all settings will save automatically and exit weekly timer mode.

XII. Enabling or Disabling the Weekly timer

Once at least one timer group has been fully configured (Selected day(s), time period, target temperature, and heater level)

The weekly timer can be turned ON or OFF as follows:

- Ensure the remote control is OFF (the display is on, but the flame, fuel bed, and top light icons are not shown).
- Short press the Timer button (Button 12).

The Timer 7/24 indicator on the top-left of the display will toggle:

- Shown → Weekly timer enabled
- Not shown → Weekly timer disabled

Note:

If a timer group is set with the heater level set to OFF, the appliance will still switch ON at the scheduled time, but without heating. In this case, only the flame and lighting functions will operate.

IX. Programme and Timer Examples:

Example 1 – Simple daily schedule

- Monday to Sunday, 6:00 pm to 9:00 pm, target temperature 24 °C, Low heat
- **1 timer group is sufficient.**

Example 2 – Different weekday and weekend times

- Monday to Sunday, 6:00 pm to 9:00 pm
- Saturday and Sunday, 4:00 pm to 6:00 pm
- Target temperature 24 °C, Low heat
- **2 timer groups are required.**

Example 3 – Multiple schedules on the same day

- Monday to Sunday, 6:00 pm to 9:00 pm
- Saturday and Sunday, 4:00 pm to 6:00 pm
- Saturday and Sunday, 6:00 am to 10:00 am
- Target temperature 24 °C, Low heat
- **3 timer groups are required.**

X. Setting a Timer Group

After selecting a timer group, the setup proceeds in the following order.

1. Select Day(s) of Operation

- Days are shown starting from Monday (MON).
- Use Adjust (+ / -) to toggle the current day ON or OFF.
- Press Timer (Button 12) to confirm and move to the next day.
- Repeat for all required days until all selections are complete.

2. Set Start and End Time

- Set the start time (hour → minute) using Adjust (+ / -).
- Press Timer (Button 12) to confirm each step.
- Set the end time in the same way.

3. Set Temperature and Heat Level

- Set the desired temperature using Adjust (+ / -).
- Press Timer (Button 12) to confirm.
- Select the heater level: OFF, Low (L), High (H)

Important: If the heater level is set to OFF, heating will not activate, even if a target temperature is set.

- Press Timer (Button 12) to confirm, the selected timer group is now complete.

a. Remote Control Overview:

Buttons 1–9 provide the core day-to-day controls for the appliance, including power, lighting adjustment, flame effects, heat selection, and quick lighting restore.

In addition to Buttons 1–9, which are used for regular day-to-day operation, the remote includes three advanced controls:

- Button 10 – Mode :** Cycles lighting mode effects.
- Button 11 – Adjust (+ / -):** Used to adjust values such as time, temperature, and settings within advanced menus.
- Button 12 – Timer:** Used to access timer functions.

Buttons 11 (+ / -) and 12 (Timer) work together to configure daily and weekly timer schedules. These advanced functions allow precise and flexible control but may require careful setup when used for the first time.

b. Lighting Control

Colour and Brightness adjust all lighting together, unless a specific zone is selected.

To adjust one zone only, press Flame / Fuel Bed / Top Light.

The selected zone will flash once to confirm selection, then:

- Press Colour to change colour
- Press Brightness to change brightness

Note: On LCD models, Colour adjustment does not alter flame video scenes.

c. Setting the Target Temperature

Press the Heat button to activate heating and enter temperature setting mode.

While the temperature value on the display is flashing (target temperature setting), use the Adjust (+ / -) buttons to set the desired temperature (between 10°C -30°C).

After approximately 5 seconds with no input, the flashing stops, confirming the setting has been stored.

The heater will automatically operate based on the selected temperature. (For details on automatic temperature control behaviour, refer to Section 13. Heating System.)

Press Restore Button (No. 9) to restore default lighting settings. After restoring, press Colour or Brightness to adjust the full lighting set again.

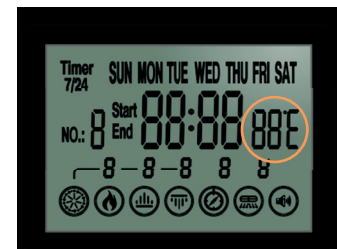

d. Advanced Functions

I. Mode:

The Mode function provides a range of preset lighting configurations which cycle through different colour and rhythms automatically (each one is different).

To select your preferred mode, press the Mode button (Button 10) to choose from the 7 options (Mode 1-7).

II. Global Mode:

If no specific lighting zone (Flame Picture, Fuel Bed, or Top Light) is selected, the selected mode will apply to all zones simultaneously:

- Flame picture (LED models only)
- Fuel bed
- Top light

(On LCD models, the flame picture zone is not applicable.)

III. Individual Zone Mode:

To apply a mode to a single zone only:

- Select the desired zone (Flame picture / Fuel Bed / Top Light).
- Press the Mode button 1-7 times to select the required mode.
- The selected zone will operate independently using the chosen mode.

IV. Timer Functions:

The timer allows the appliance to automatically switch OFF after a selected period of time.

Setting the Sleep Timer:

- Wake up the remote control.
- The display will show the flame picture, fuel bed, and top light icons.
- Short press the Timer button (Button 12) to enter sleep timer setting mode.
- Use the Adjust (+ / -) buttons to select the desired operating time (1-8 hours, 0 = cancel timer).

Confirming and Saving

Short press the Timer button (Button 12) to exit and save the setting, or Wait for 5 seconds with no input to automatically exit and save.

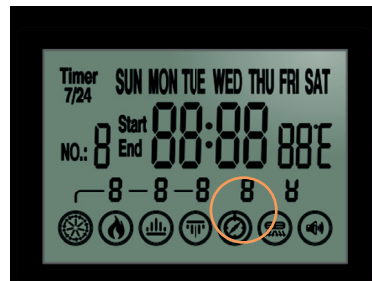

V. Confirmation Display (LCD models):

After saving, a confirmation message will be shown on the display, for example:

- 0 → Shutdown cancelled
- 1 → Timing shutdown: 60 minutes
- 8 → Timing shutdown: 480 minutes

Once the set time has elapsed, the appliance will switch OFF automatically.

VI. Setting Day and Time:

Wake up the remote control.

- The display will show the flame picture, fuel bed, and top light icons.
- Press and hold the Timer button (Button 12) for 5 seconds to enter day and time setting.
- Notice that the day of the week will start to flash.
- Use Adjust (+ / -) to select the current day.
- Press Timer (Button 12) to confirm.
- Set the hour, then the minute, using Adjust (+ / -).
- Press Timer (Button 12) after each step to confirm.

Confirming and Saving

- After confirming day, hour, and minute, the setting will exit and save automatically or If no button is pressed for more than 10 seconds, the current setting will be saved automatically and exit.

VII. Weekly Timer (programme)

The weekly timer allows the appliance to operate automatically on selected days, within defined time periods and heat settings.

- Ensure the remote control is OFF (*the display is on, but the flame picture, fuel bed, and top light icons are not shown*).
- Press and hold the Timer button (Button 12) for 5 seconds to enter weekly timer setup.
- Timer Group number (0-9) will flash.
- Use Adjust (+ / -) to select a timer group.

VIII. Understanding Programmes and Timer Groups

A programme can use one or more timer groups to build your weekly schedule. Each timer group represents one complete on/off schedule, and up to **10 timer groups (0-9)** are available.

- Selected day(s) of the week
- Start time
- End time
- Target temperature
- Heater level (Off / Low / High)

By combining multiple timer groups, more complex weekly schedules can be created.